

\*Aberturas de acordo com as representações em 3D.

Item 1.1 - Armário aberto

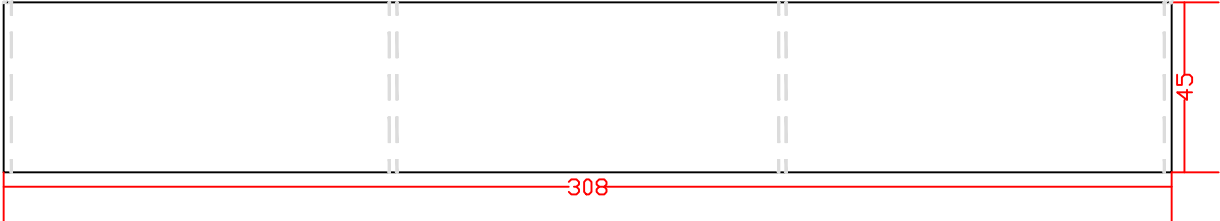

Vista Superior

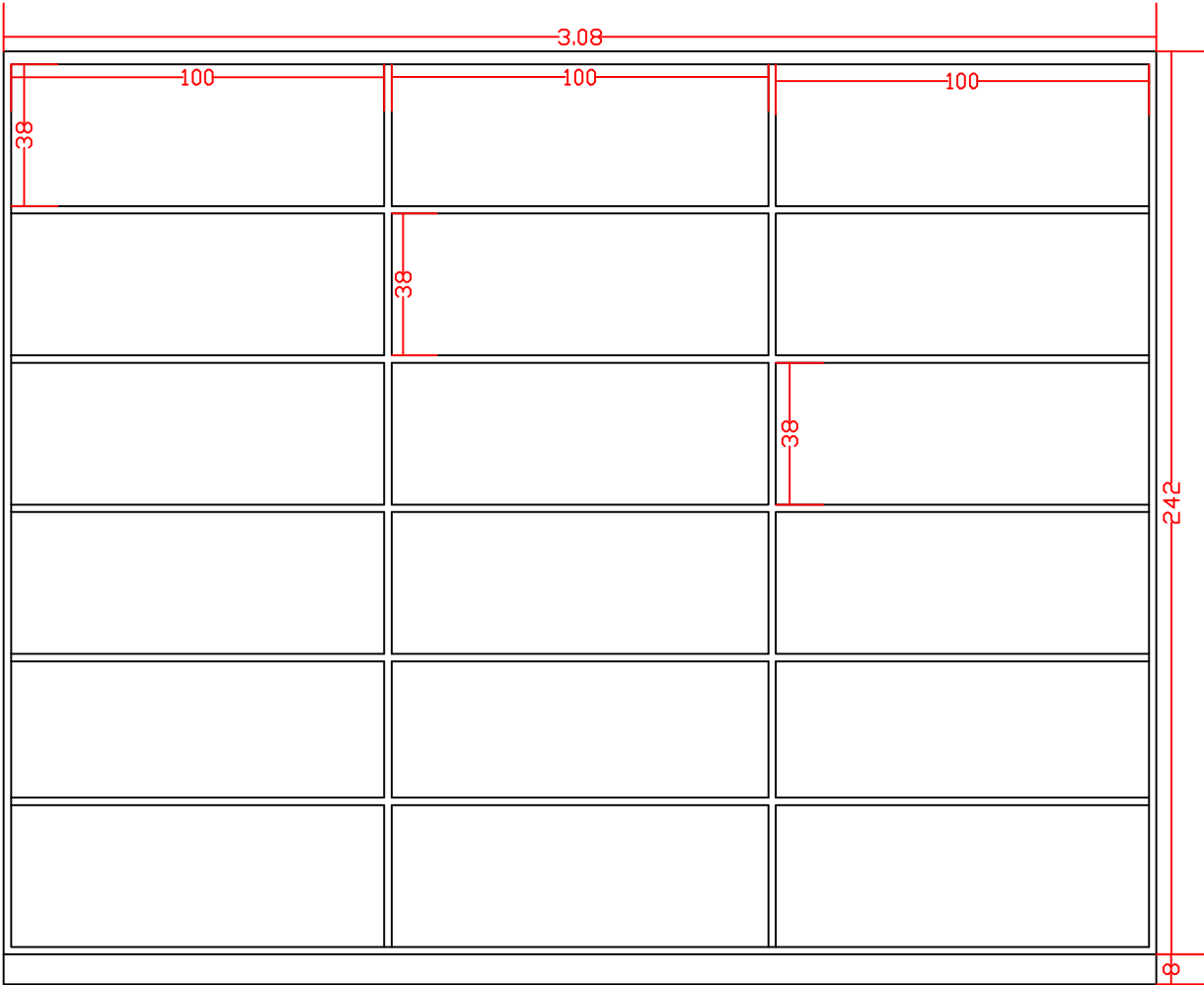

Vista Frontal

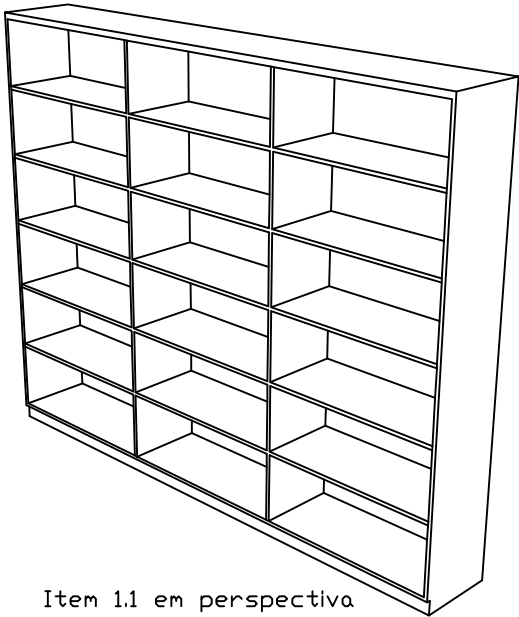

Item 1.1 em perspectiva

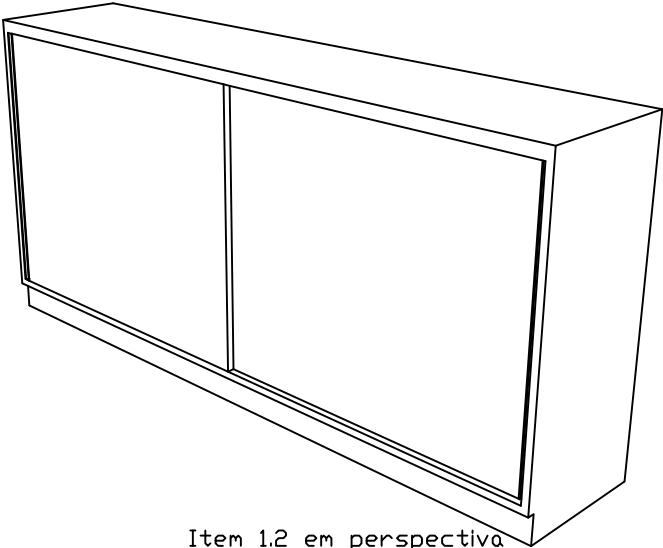

Item 1.2 em perspectiva

Item 1.2 - Balcão

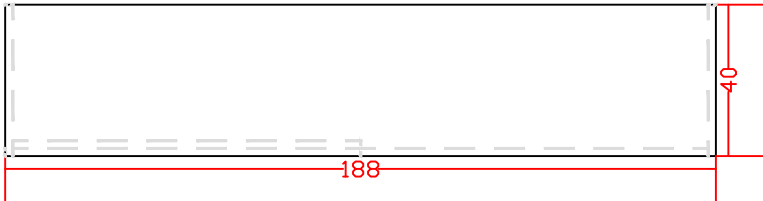

Vista Superior

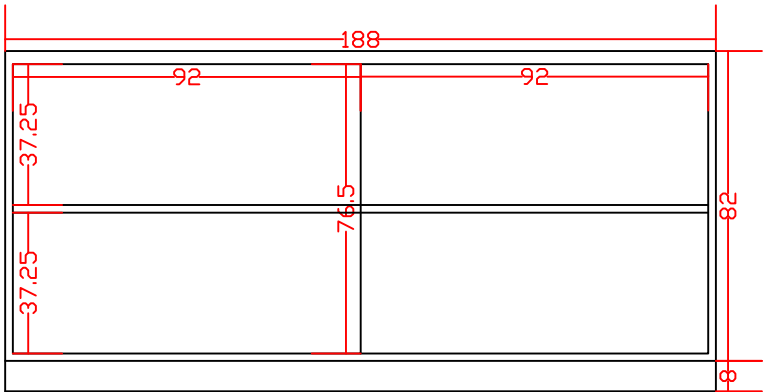

Vista Frontal

PROJETO MOBILIÁRIO - ALMOXARIFADO		ARQUIVO R 01
Prefeitura Municipal de Cotiporã CNPJ: 90.898.487/0001-64		DATA MARÇO/2020
		DESENHO ANDRÉ R. SACHINI
		ESCALA 1/20
MOBILIÁRIO - DETALHAMENTO MÓVEIS UBS ITENS 1.1 e 1.2		PRANCHA 01