

Item 1.23 - Armário

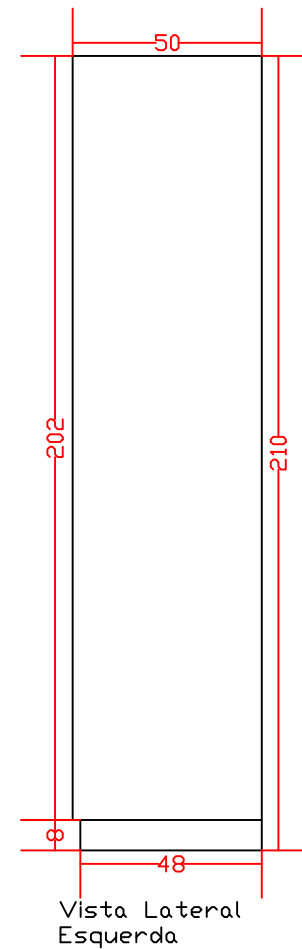

Item 1.24 em perspectiva

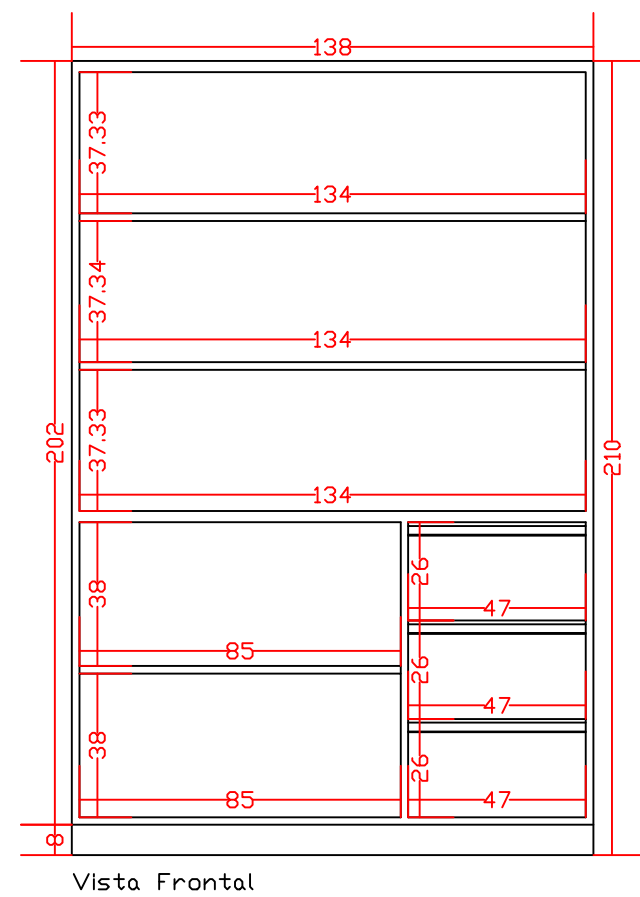
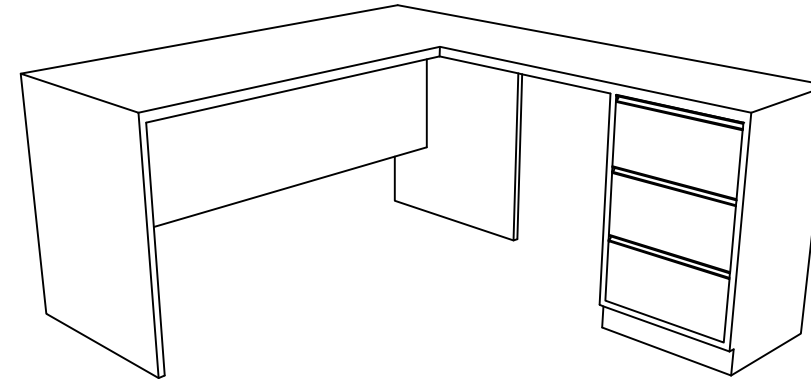

Item 1.24 - Mesa com gaveteiro

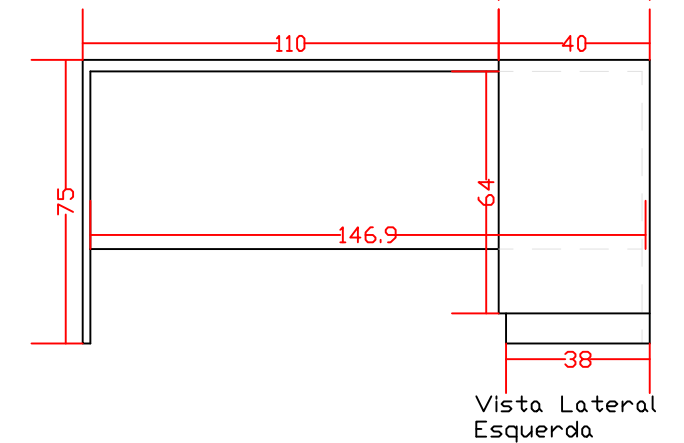
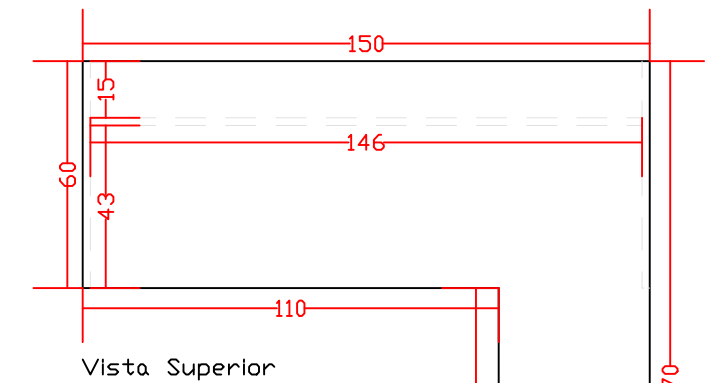
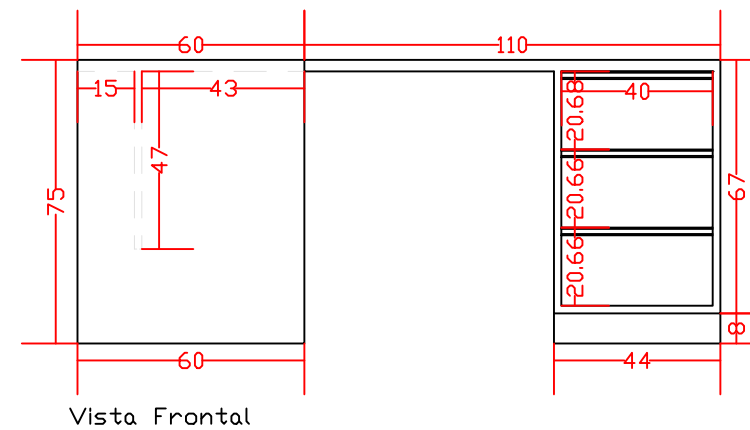

Item 1.23 em perspectiva

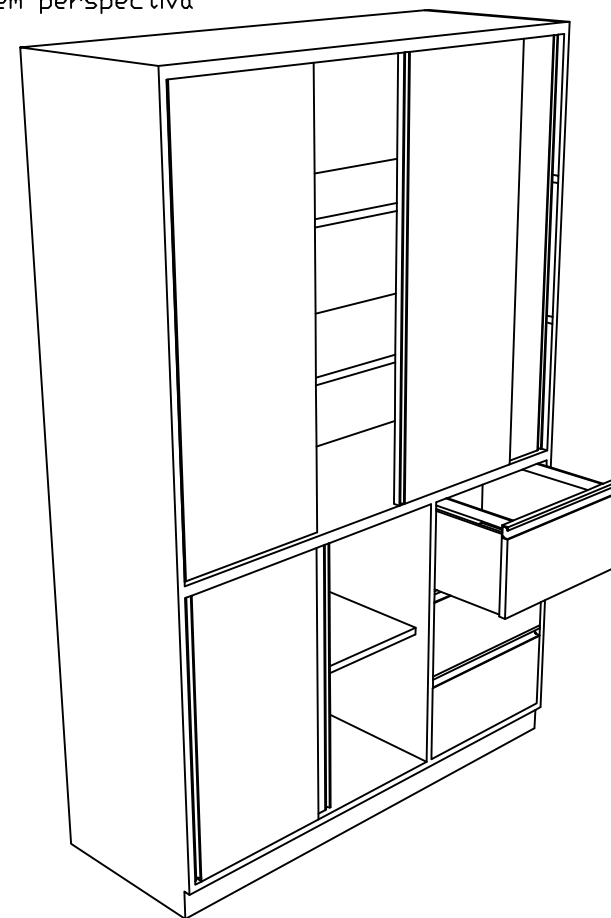

Gaveta para item 1.23

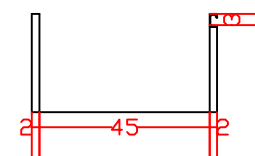
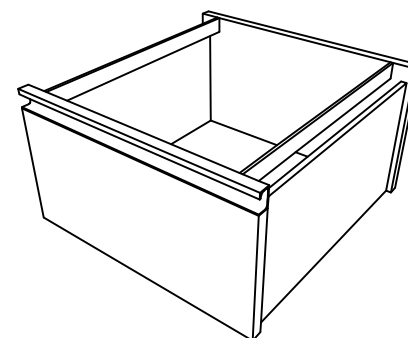
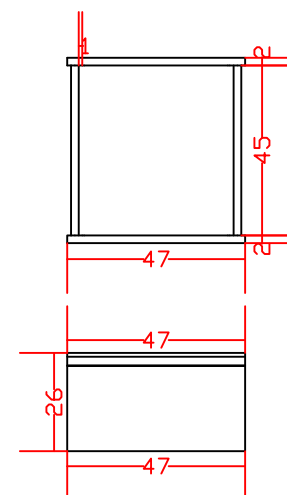

PROJETO MOBILIÁRIO - VIGILÂNCIA SANITÁRIA

Prefeitura Municipal de Cotiporã

CNPJ: 90.898.487/0001-64

MOBILIÁRIO - DETALHAMENTO

MÓVEIS UBS
ITENS 1.23 e 1.24

ARQUIVO	R 01
DATA	MARÇO/2020
DESENHO	ANDRÉ R. SACHINI
ESCALA	1/20

PRANCHA

14

*Aberturas de acordo com as representações em 3D.