

Item 1.27 em perspectiva

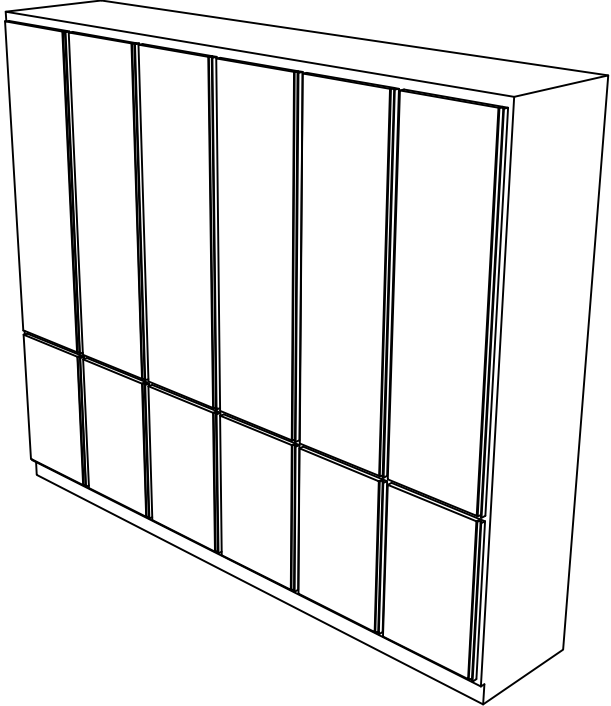

Item 1.27 - Armário fechado

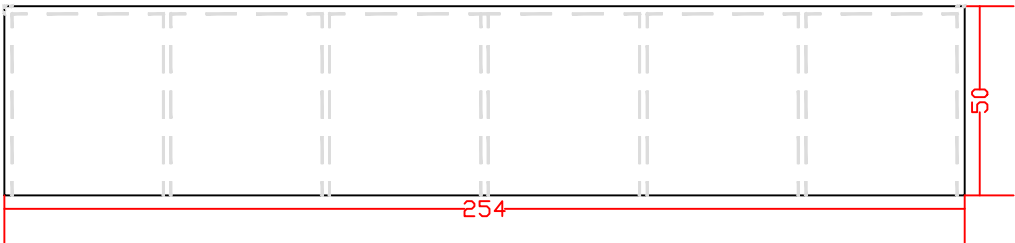

Vista Superior

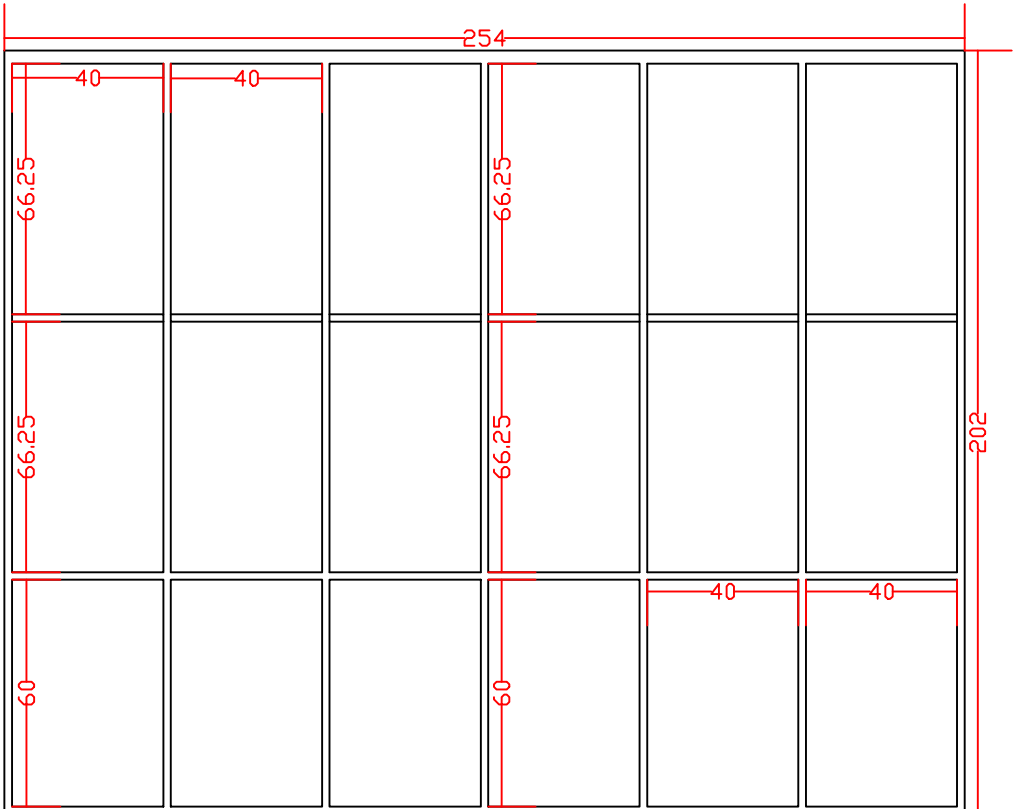

Vista Frontal

*Aberturas de acordo com as representações em 3D.

Item 1.28 em perspectiva

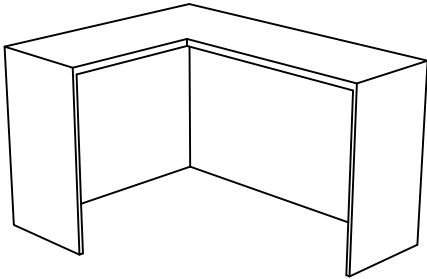

Item 1.28 - Mesa em "L"

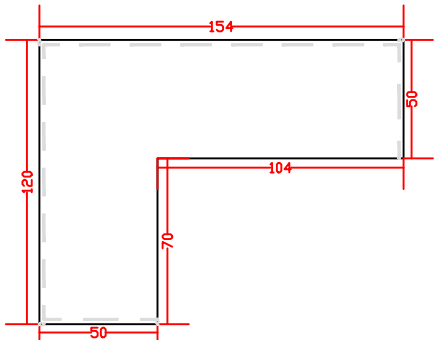

Vista Superior

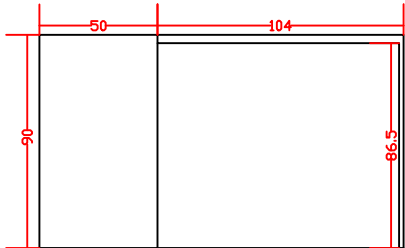

Vista Frontal

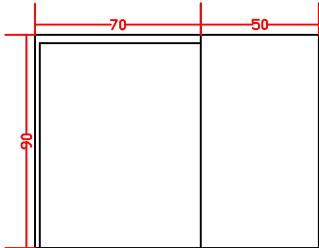

Vista Lateral Esquerda

PROJETO MOBILIÁRIO - ALOJAMENTO		ARQUIVO R 01
Prefeitura Municipal de Cotiporã CNPJ: 90.898.487/0001-64		DATA MARÇO/2020
		DESENHO ANDRÉ R. SACHINI
		ESCALA 1/20
MOBILIÁRIO - DETALHAMENTO MÓVEIS UBS ITENS 1.27 e 1.28		PRANCHA 16